

James M Lane

Richard Tobb

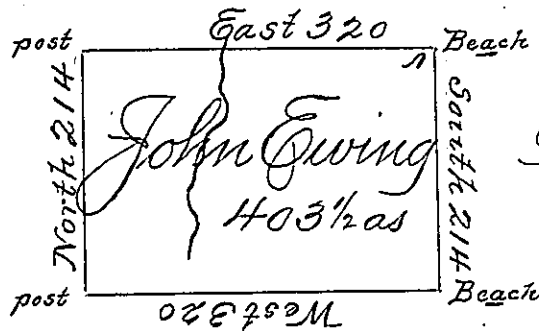

Benj S. Barton

Edw<sup>d</sup> Burd

Situate on the Waters of Lake Erie in Allegheny  
 County District N<sup>o</sup> 1 Surveyd 16 June 1794 to  
 John Ewing on his warrant dated 13 April 1792  
 Containing Four hundred three Acres an half & allow<sup>t</sup>

Tho<sup>s</sup> Rees Df

Danl Brodhead Esq }  
 Sur<sup>v</sup> Gen<sup>l</sup> }

IN TESTIMONY that the above is a copy of the original remaining on file in  
 the Department of Internal Affairs of Pennsylvania, made  
 conformably to an Act of Assembly approved the 16th day of  
 February, 1833, I have hereunto set my Hand and caused  
 the Seal of said Department to be affixed at Harrisburg,  
 this fourth day of November 1902.

James W. Fatta  
 Secretary of Internal Affairs.